

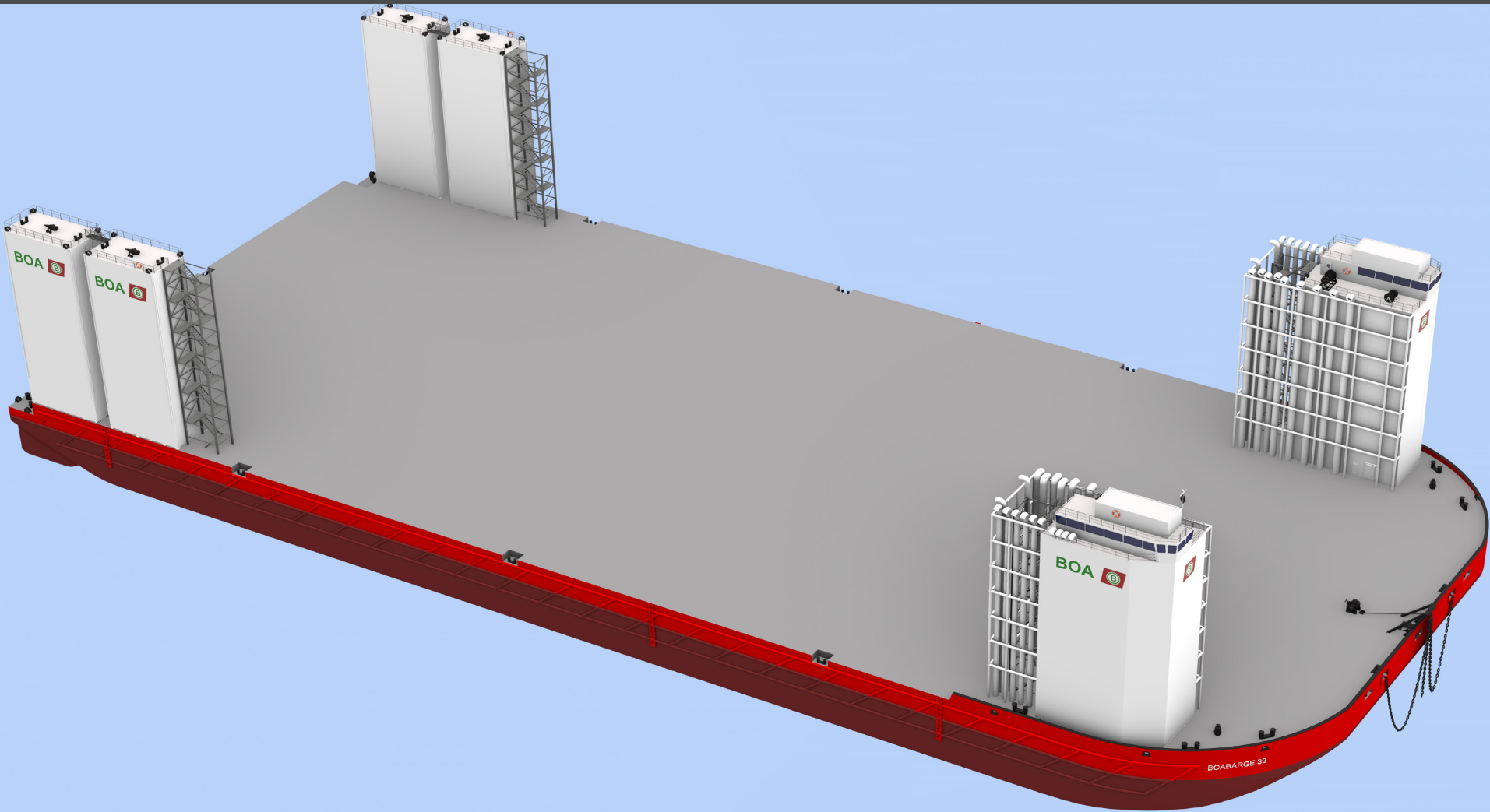

BOA



BOA BARGE 39/40

Next generation semi-submersible and heavy lift cargo barges

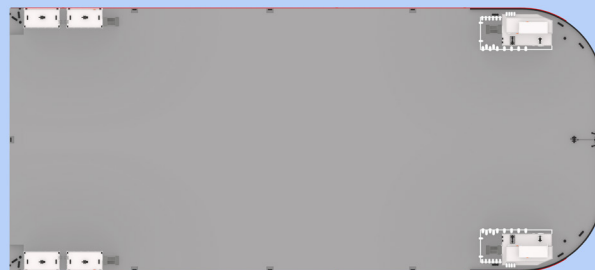
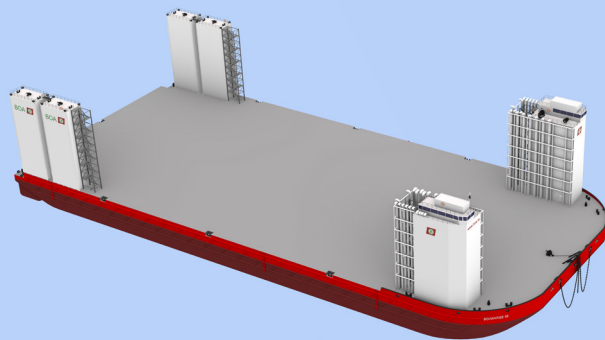
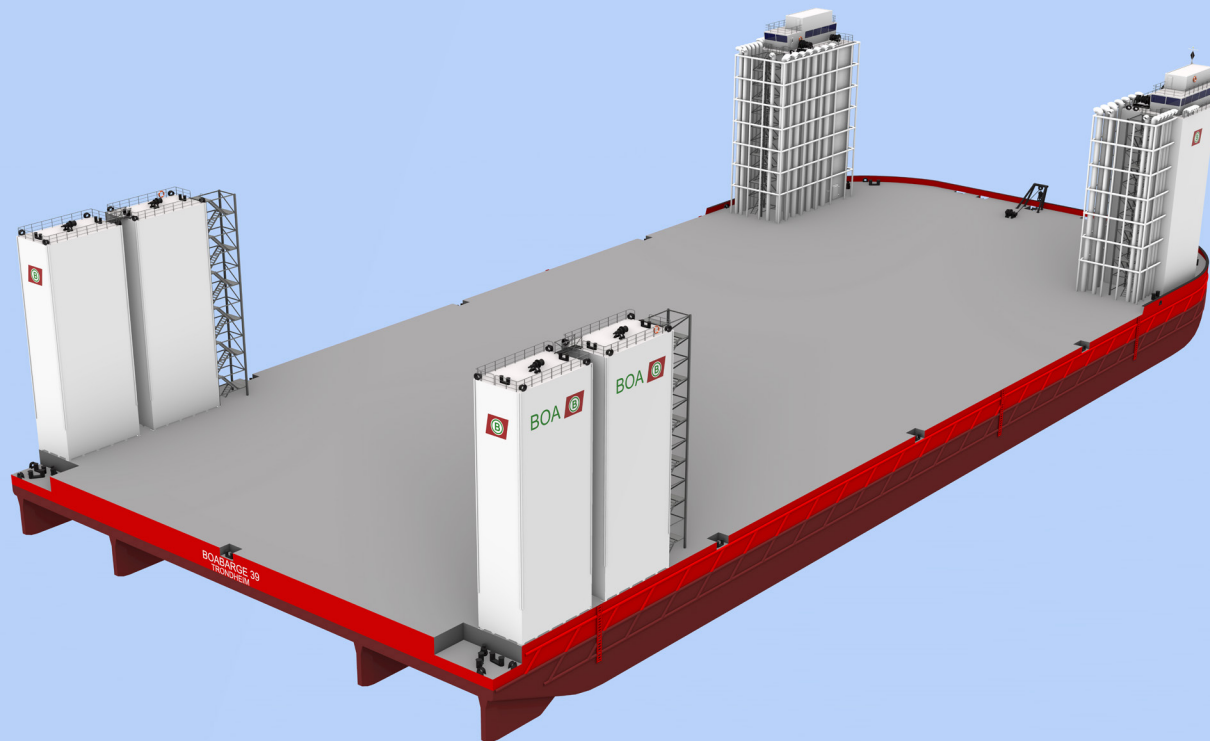

DESIGN

Dimensions

Length, Overall	166 m
Breadth, Moulded	73.38 m
Depth, moulded	9.15 m

Cargo Capacities

Deadweight	Approx. 75.000 t
Deck strength	35 t/m ²

Submerging Capacities

Submerging depth above deck	22.5 m
Ballast pumps capacity	20.000 m ³
4 x Removable floatation towers	

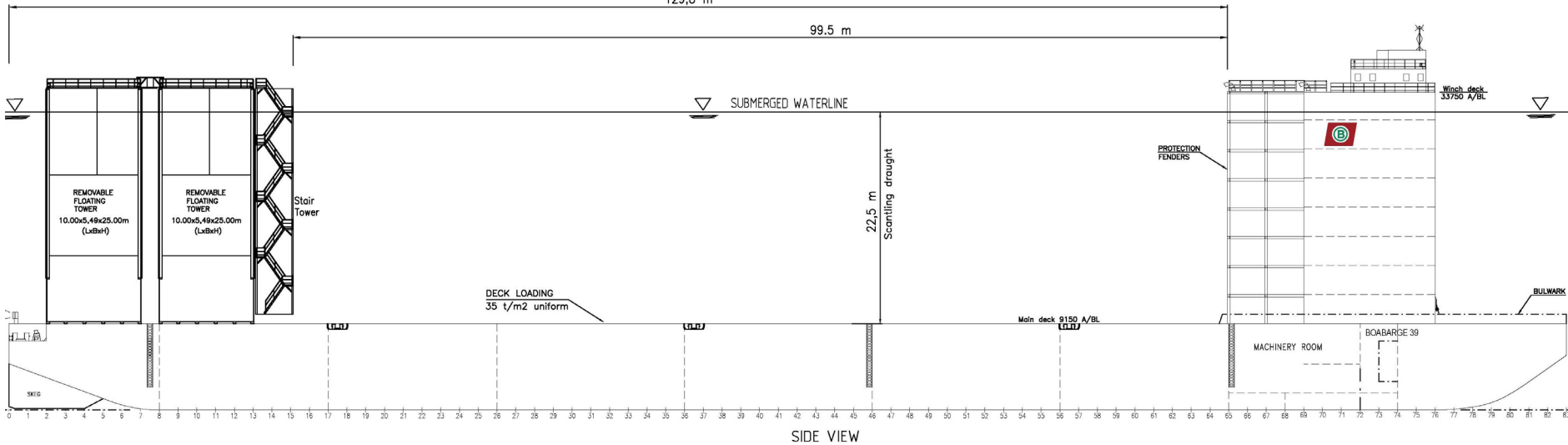
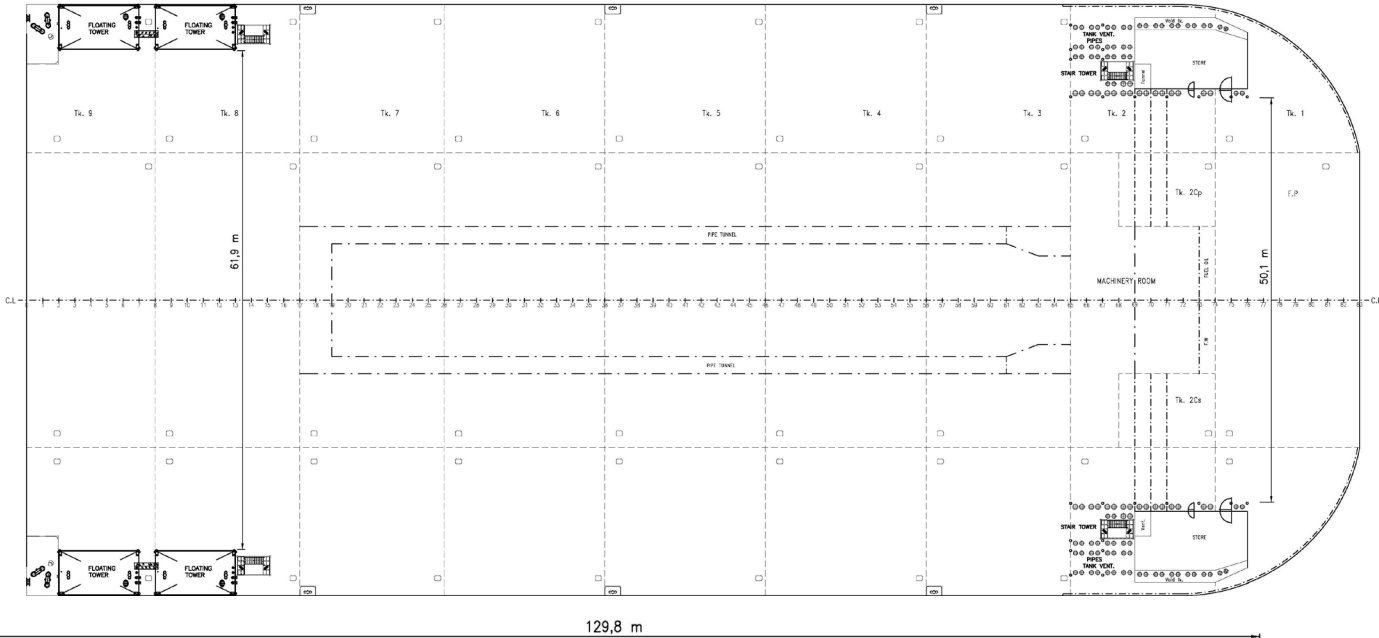

SIDE VIEW

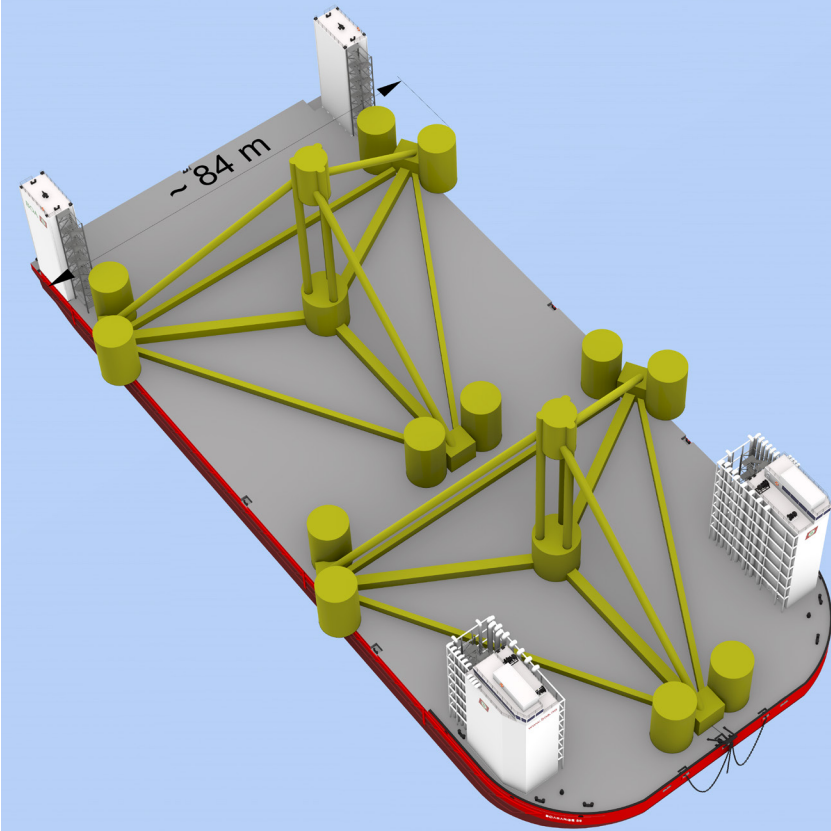

KEY FEATURES

- Dimensions 166 x 73.38 x 9.15 m
- Submerging capacities of 22.5 m above deck
- Heavy cargo up to approx. 75.000 t
- Deck strenght of 35 t/m²
- Ballast pump capacity of 20.000 m³/h
- 4 removable floatation towers
- Hybrid operation battery/generators/shore power



UNIQUE DESIGN

Due to its versatile design and unique features, the Boabarge 39 is suitable to support a wide range of operations in various industries, such as;

- Load-out/Float-off operations
- Transport of vessels, rigs and heavy loads
- Drydocking operations
- Salvage operations
- Platform for construction and installation
- Decom operations

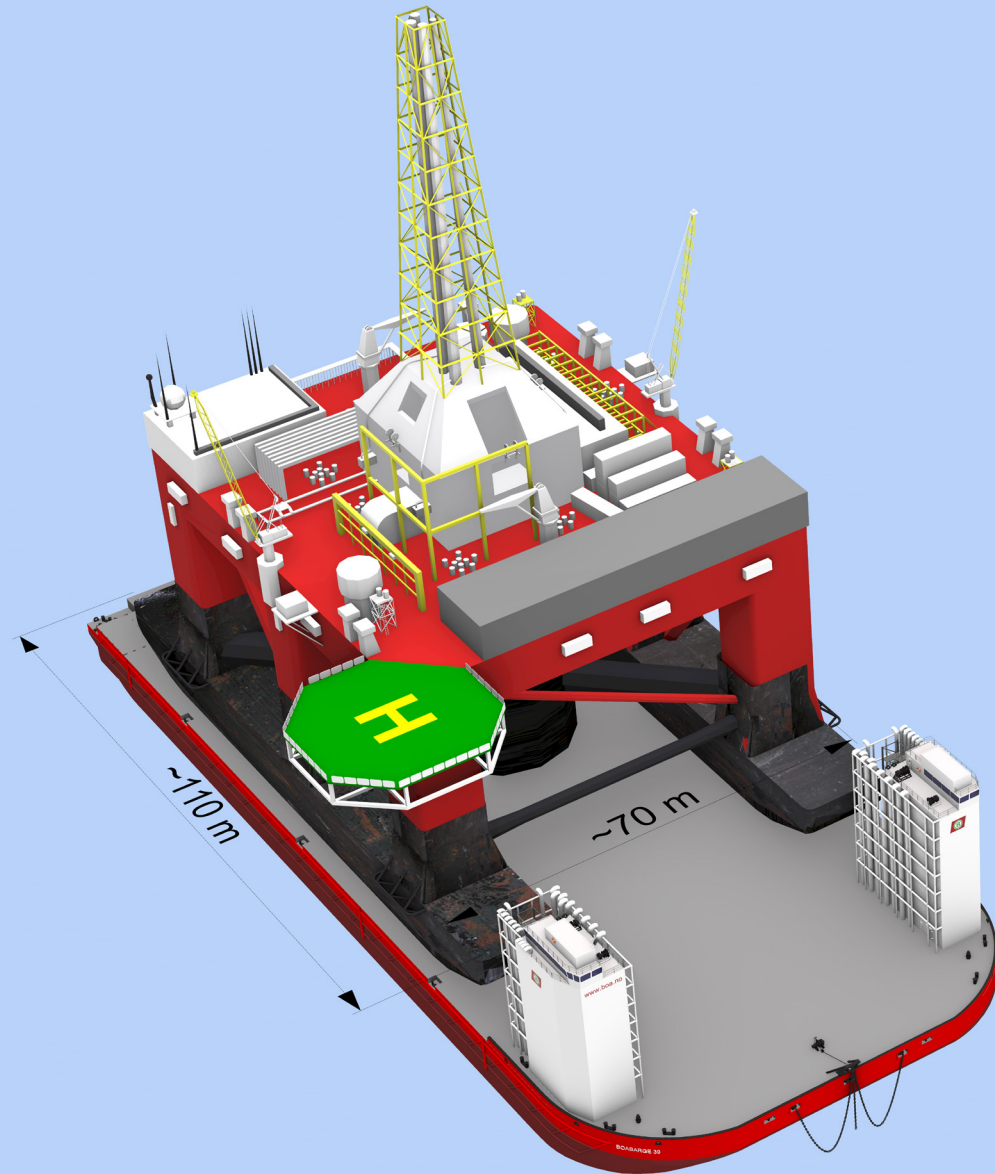

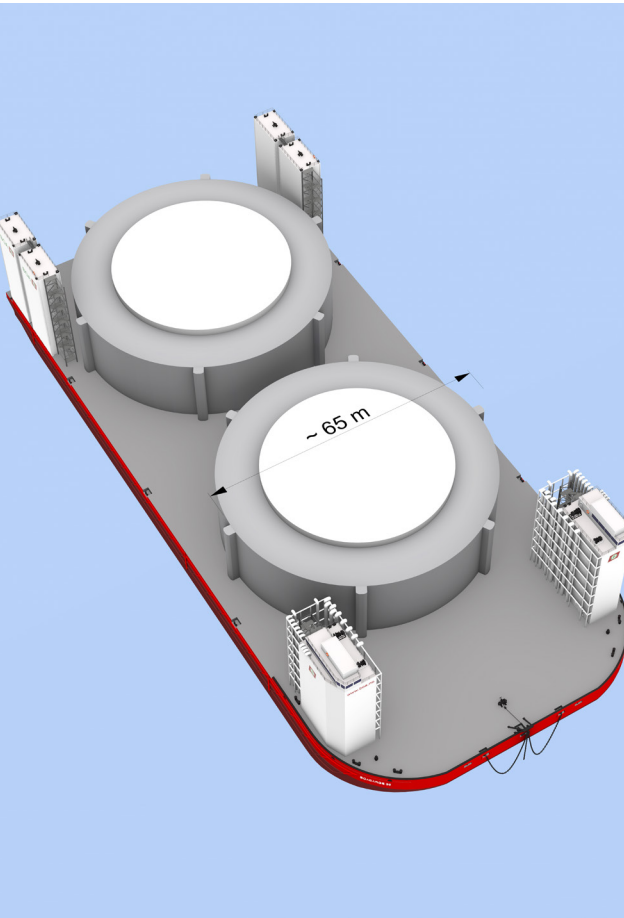

Offshore wind

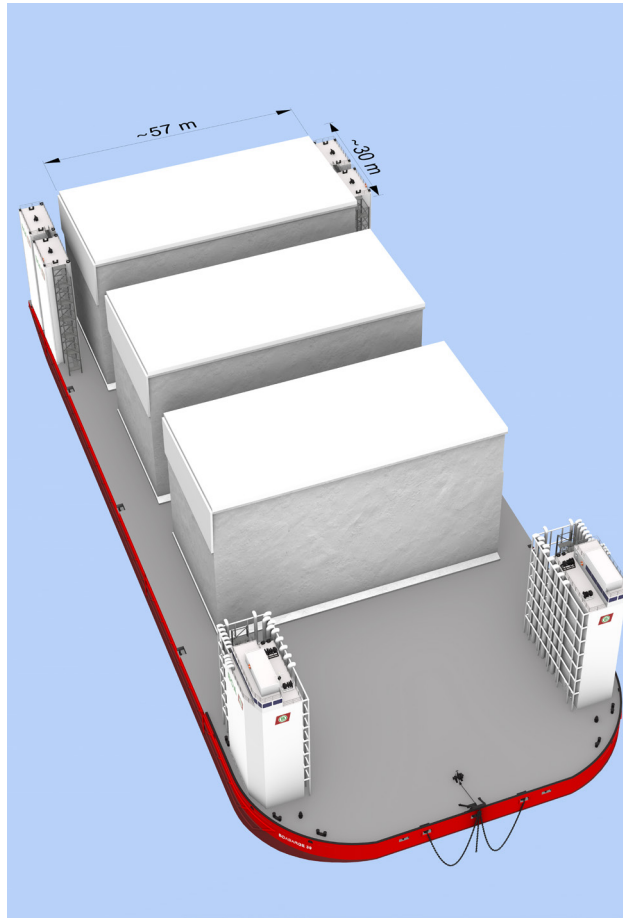

Civil Construction

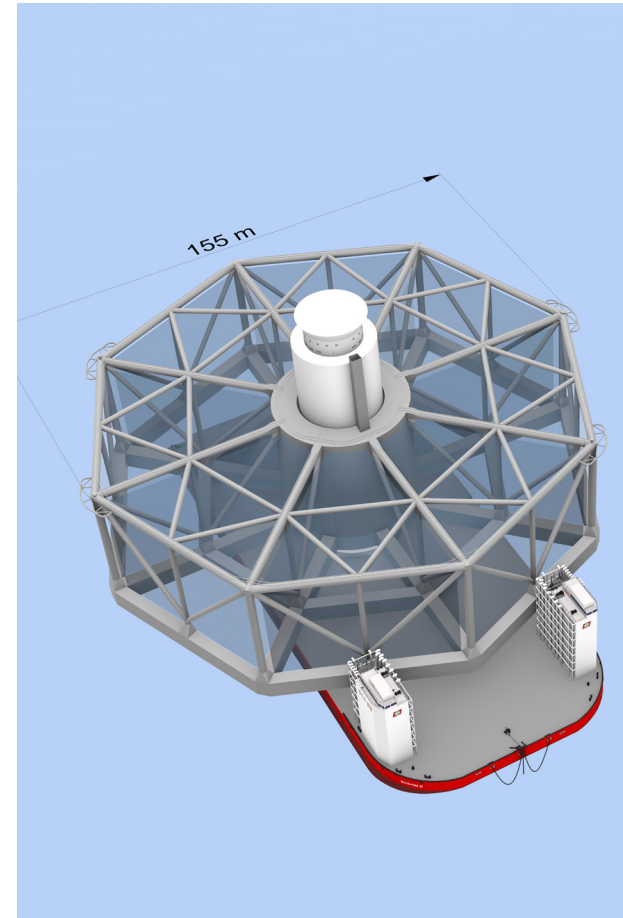

Fish Farms



Drydocking

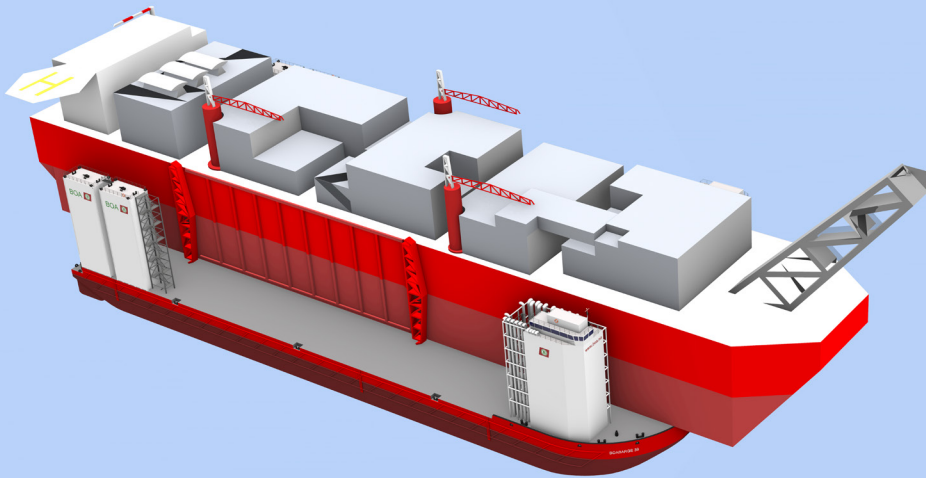





CORPORATE HEADQUARTERS

BOA Management AS
Strandveien 43
7067 Trondheim
Norway
+47 73 99 11 99
chartering@boa.no

www.boa.no

Every effort has been made to ensure that all information contained in this brochure is accurate and up-to-date, however all specifications are subject to change without notice and should be verified. Boa accepts no liability or responsibility for any action taken based on the information presented in this brochure. Boa encourages interested parties to verify the contents of this brochure when in doubt.